

ERST 20-X - 15.9mm (5/8") Truss Head Lock Bolt

Unit:mm/(inch)

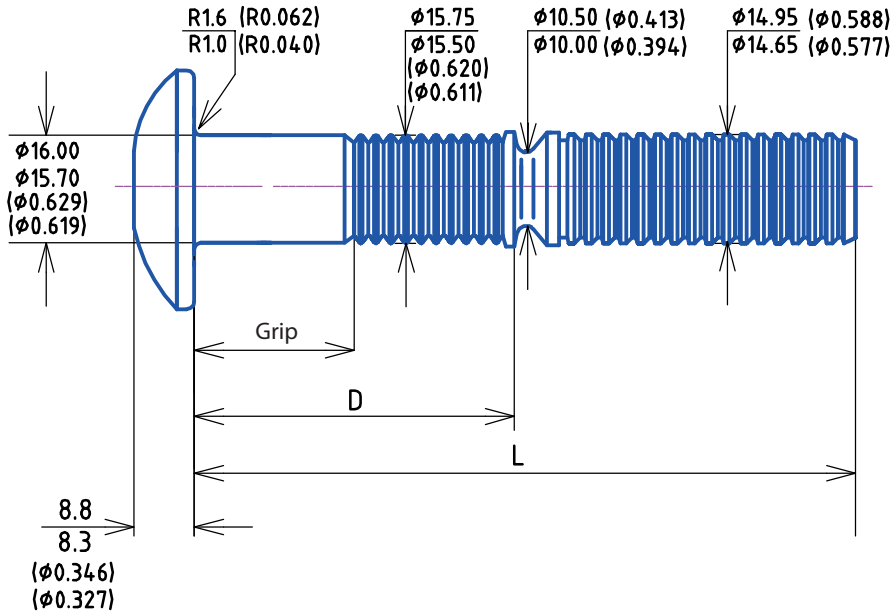

Letter Showing:

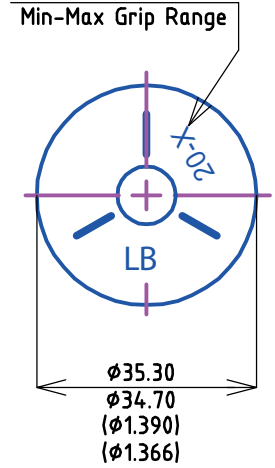

Technical Requirements

Min Ultimate Tensile:	121 (KN)	Max Pin Protusion:	9.5 (mm)
Clamping Load:	85 (KN)	Max Pin Intrusion:	1.6 (mm)
Min Shear Strength:	100 (KN)	Surface Treatment:	Black and Oiled
Max Hole Diameter:	17.5 (mm)	Raw Material Specification:	Alloy Steel

5/8"	Part Number	Grip (mm)		Grip (inch)		D (mm)		D (inch)		L (mm)		L (inch)		Head Marking
		Min	Max	Min	Max	Min	Max	Min	Max	Min	Max	Min	Max	
20-4	ERST20-04	6.35	12.7	0.25	0.5	35.9	36.9	1.42	1.45	91.4	95.9	3.6	3.77	20-4
20-8	ERST20-08	12.7	19.05	0.5	0.75	42.2	43.2	1.67	1.7	97.7	102.2	3.85	4.02	20-8
20-12	ERST20-12	19.05	25.4	0.75	1	48.6	49.6	1.92	1.95	104.1	108.6	4.1	4.27	20-12
20-16	ERST20-16	25.4	31.75	1	1.25	54.9	55.9	2.17	2.2	110.4	114.9	4.35	4.52	20-16
20-20	ERST20-20	31.75	38.1	1.25	1.5	61.3	62.3	2.42	2.45	116.8	121.3	4.6	4.77	20-20
20-24	ERST20-24	38.1	44.45	1.5	1.75	67.6	68.6	2.67	2.7	123.1	127.6	4.85	5.02	20-24
20-28	ERST20-28	44.45	50.8	1.75	2	74	75	2.92	2.95	129.5	134	5.1	5.27	20-28
20-32	ERST20-32	50.8	57.15	2	2.25	80.3	81.3	3.17	3.2	135.8	140.3	5.35	5.52	20-32
20-36	ERST20-36	57.15	63.5	2.25	2.5	86.7	87.7	3.42	3.45	142.2	146.7	5.6	5.77	20-36
20-40	ERST20-40	63.5	69.85	2.5	2.75	93	94	3.67	3.7	148.5	153	5.85	6.02	20-40
20-44	ERST20-44	69.85	76.2	2.75	3	99.4	100.4	3.92	3.95	154.9	159.4	6.1	6.27	20-44
20-48	ERST20-48	76.2	82.55	3	3.25	105.7	106.7	4.17	4.2	161.2	165.7	6.35	6.52	20-48